



Flat 81, 2, Arber House Greenleaf Walk, Southall, UB1 1FR  
**£2,100 Per Month**



## Flat 81, 2, Arber House Greenleaf Walk, Southall, UB1 1FR

**£2,100 Per Month**

Welcome to this modern apartment located on the desirable Greenleaf Walk in UB1. This contemporary residence, built in 2021, offers a perfect blend of style and comfort, making it an ideal choice for everyone.

Spanning an impressive 768 square feet, the apartment features a spacious reception room that provides a warm and inviting space for relaxation and entertainment. The well-designed layout includes two generously sized bedrooms, ensuring ample space for rest and privacy. With two bathrooms, including an en-suite, convenience is at your fingertips, catering to the needs of a busy lifestyle.

The property is situated in a vibrant area, with easy access to local amenities, parks, and excellent transport links, making it a fantastic option for commuters and families alike. The modern design and high-quality finishes throughout the apartment create a welcoming atmosphere that you will be proud to call home.

This apartment is not just a place to live; it is a lifestyle choice that offers comfort, convenience, and a sense of community. Don't miss the opportunity to make this stunning property your own.

Parking space is available for an additional fee.

## Description



## Situation

Furnished  
Council Tax Band: B  
Available: 8th May 2026

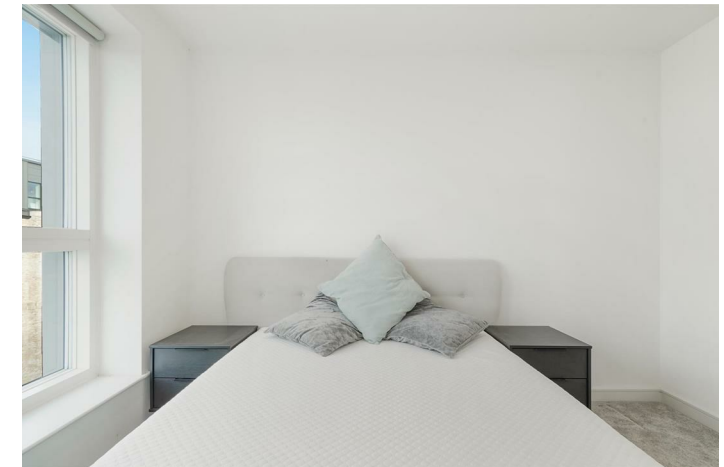

## Floor Plans

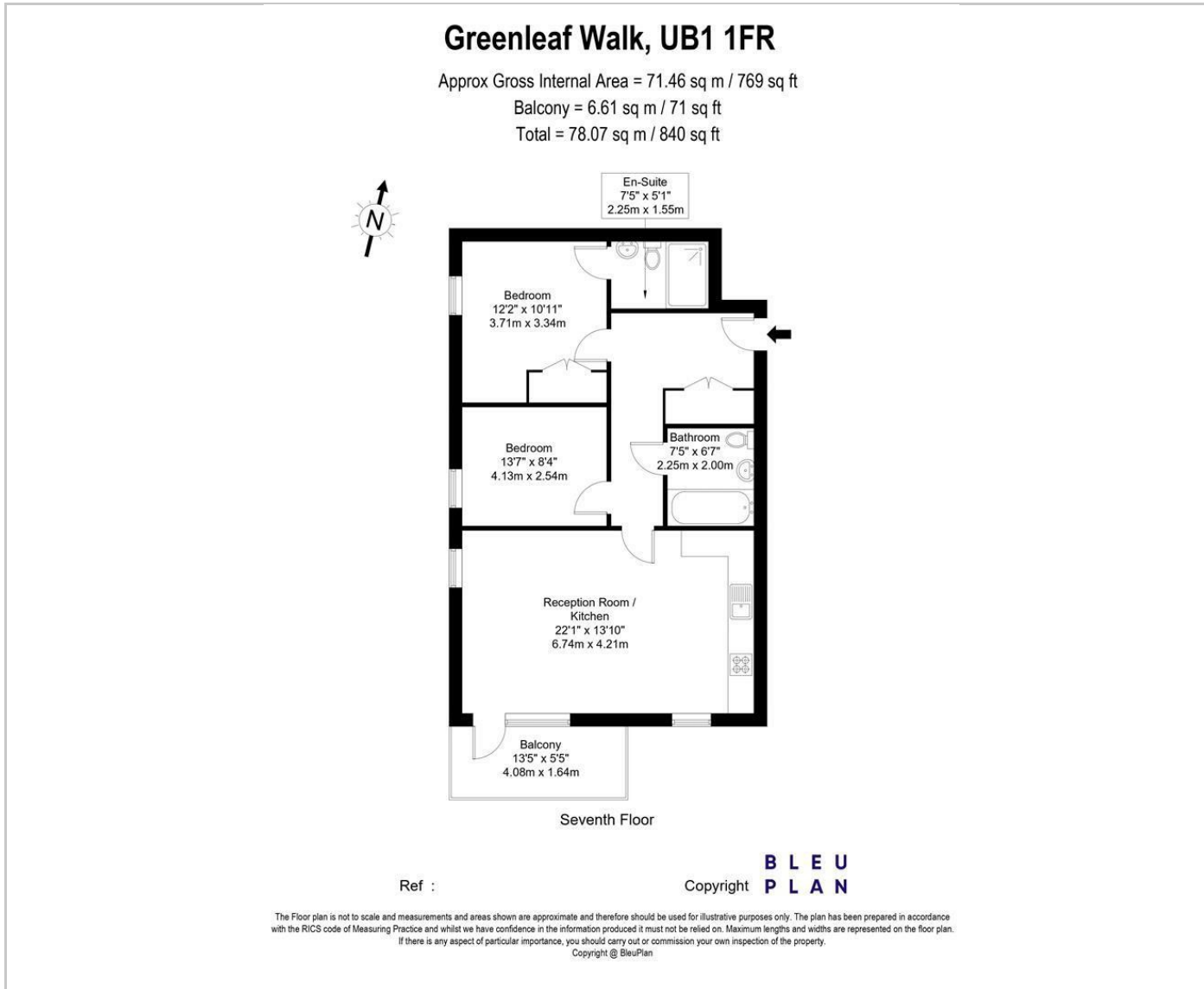

## Area Map

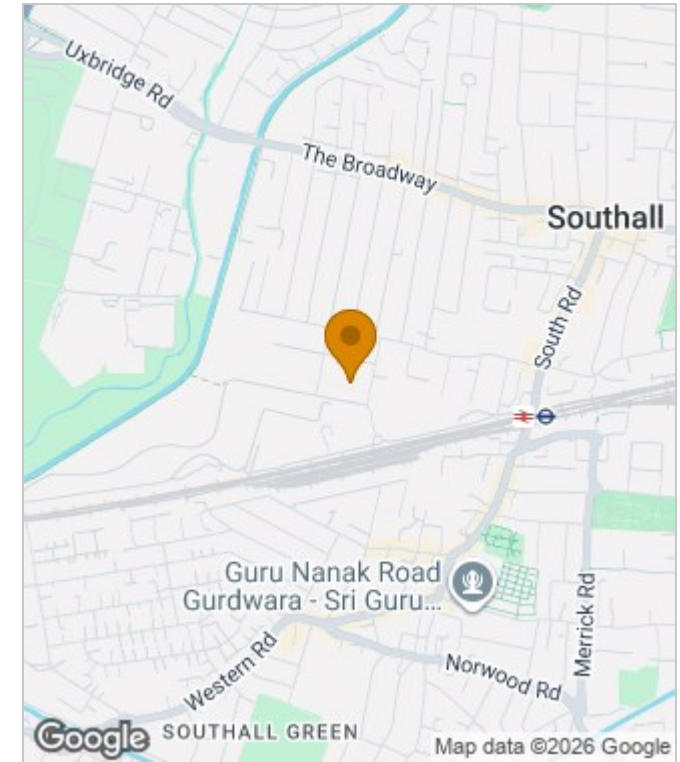

## Energy Performance Graph

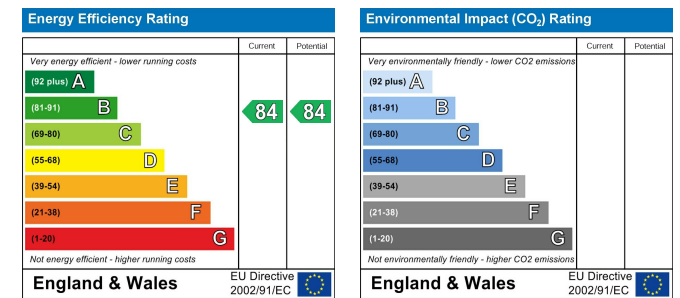

These particulars, whilst believed to be accurate are set out as a general outline only for guidance and do not constitute any part of an offer or contract. Intending purchasers should not rely on them as statements of representation of fact, but must satisfy themselves by inspection or otherwise as to their accuracy. No person in this firm's employment has the authority to make or give any representation or warranty in respect of the property.